

STAKING & DIMENSIONING NOTES

1. Discrepancies found in base data or property boundaries should be reported immediately to the Engineer.
2. The center stakes for the tees, greens, catch basins and other key points shall be staked in the field by the Contractor. All dimensioning of the golf course features are based on these lines of staking. No other reference lines or angles should be used for dimensioning purposes unless otherwise shown or indicated on the plans.
3. The Contractor shall have the staking reviewed by the Owner before proceeding with construction. The Contractor shall retain a registered land surveyor to establish vertical control and to verify all principal staking coordinates.
4. Written dimensions shall prevail to the limits of accuracy as established by the dimensions on the plans. Contractor shall not scale drawings. Contractors are expected to use digital measurement tools and GIS to locate, stake, and dimension course features.

GRADING NOTES

1. The Contractor shall insure that all areas where grading has occurred be spread with a minimum of 6 inches of topsoil (compacted depth). The top 6 inches of topsoil shall be placed on the prepared subgrade. Paper for 100' x 100' grids shall be provided and the Contractor shall be responsible for determining the method to be used to clean the topsoil of foreign material and rock.
2. All foreign material (inclusive of steel, metal, concrete, asphalt, plastic, stumps, roots, and organic matter) shall be removed from the site at the Contractor's expense and disposed of in accordance with all applicable regulations and codes.
3. Contractor is responsible for all site dewatering until final approval of the project.
4. The seeding surface shall consist of 4" of approved greens mix over a minimum of 2" in place on-site topsoil. All topsoil for tees shall be approved by the Owner prior to placement.
5. The tees shall be sloped to drain at a minimum of 1% and at a maximum of 2% in the direction shown or suggested on the plans or as directed by the Owner.

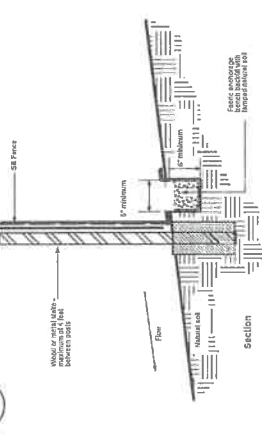
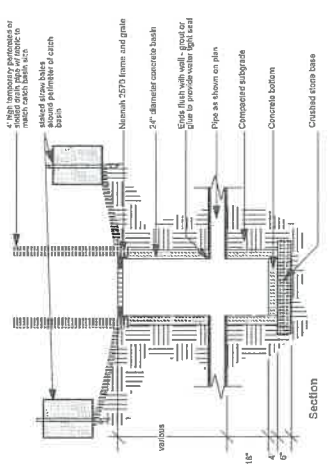
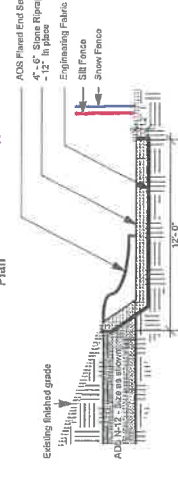
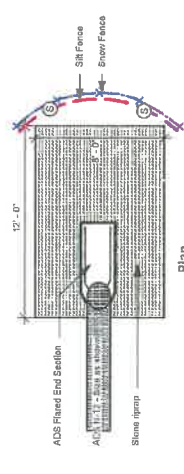
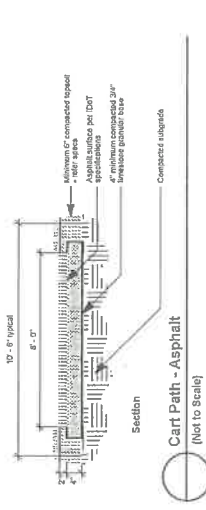

6. Greens shall consist of 10" Waupesa Soils Solutions 80/20 mix compacted in place over prepared, compacted subgrade with 12" flat tile drainage as shown as approved by the Owner.
7. All graded fairways and rough areas are to be replaced with minimum 6" on-site topsoil as approved by the Owner.

DRAINAGE NOTES:

1. All pipes shall be installed with manufacturer's approved soil light gasket assemblies. Pipe shall be installed to the grade and sloped as indicated on the drawings.
2. All 4, 6, 12, and 24 inch perforated and non-perforated shall be dual wall corrugated polyethylene pipe as manufactured by ADS, Harcor or Pfrisco, Inc., or approved equal. Perforated pipe sections shall be installed with approved gravel backfill as shown in the details.
3. Greens and bunker drain shall be 12" AdvanEDGE site drain pipe or approved equal installed per manufacturer's recommendations.
4. 12" and 24" catch basins shall be field-fabricated HOPE dual wall basins as indicated on the details with cast iron grates and sediment control barrier.
5. Areas around all catch basins, manholes and control structures shall be graded to have positive drainage to the center of the basin. All pipe inlets into the structures shall terminate flush with the inside of the structure and be grouted or glued to provide a water tight seal between the surfaces.
6. All trench bottoms shall be compacted per specifications. Pipes shall be installed per manufacturer's recommendations refer detail for bedding. Fill shall be equivalent compacted under the haunches of the pipe and then compacted in 6 to 12 inch lifts to finish grade. Contractor will be responsible for all settlement within the warranty period.
8. During construction and until final acceptance, the Contractor shall be responsible for the removal of silt and sediment from all pipes, basins, bays, basin areas, graded areas, roads, walks, drives or any other area within the Project having received sediment.

EROSION CONTROL NOTES

1. Erosion control fabric to be installed shall be DS 75 as manufactured by North American Green, Evansville, IN, 47711 and as distributed by Brook White Company, 2975 Kasota Avenue, St. Paul, MN 55105, 800.860.3210 or approved equal.
3. Fabric shall be installed around all pond edges to a minimum width of 12 feet and on disturbed areas as shown on the plans or as directed by the Golf Course Architect up to the allowance amount.
4. The contractor shall inspect all erosion and sediment control practices for stability every week. Sediment control structures shall be inspected and repaired immediately to maintain all practices as designed.
5. Sediment basins shall be cleaned out when the level of sediment reaches 2.0 ft below the top of the riser. Gravel will be cleaned or replaced when the sediment pool no longer drains properly.
6. Sediment shall be removed from behind the sediment fence when it becomes about 0.5 ft deep at the fence. The sediment fence will be repaired as necessary to maintain a barrier.
7. Sediment fencing shall be maintained throughout all construction phases.
8. During construction and until acceptance, the contractor shall be responsible for the removal of silt and sediment from all ponds, detention basin areas, graded areas, roads, walks, drives or any other area having received sediment as directed by the Golf Course Architect.
9. A minimum of 100' buffer shall be maintained around wetlands or as otherwise shown.

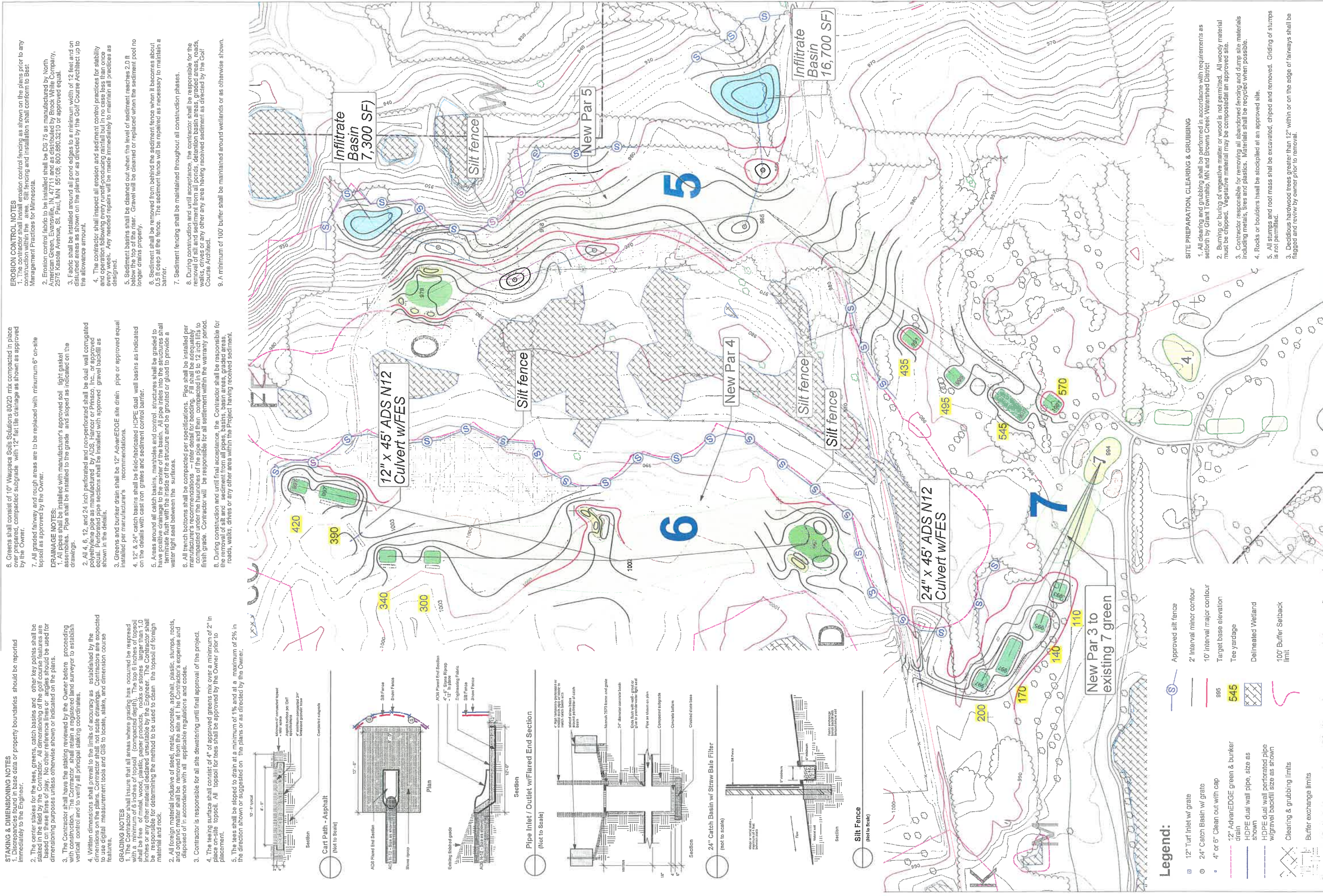

Legend:

- 12" Turf Inlet w/ grate
- 24" Catch Basin w/ grate
- 4" or 6" Clean out with cap
- 12" AdvanEDGE green & bunker drain
- HOPE dual wall pipe, size as shown
- HOPE dual wall perforated pipe w/gravel backfill size as shown
- Cleaning & grubbing limits
- Buffer exchange limits
- Approved silt fence
- 2' Interval minor contour
- 10' Interval major contour
- Target base elevation
- Tee yardage
- Delineated Wetland
- 100' Buffer Setback limit

SITE PREPARATION, CLEARING & GRUBBING

1. All clearing and grubbing shall be performed in accordance with requirements as set forth by Grant Township, MN and Browns Creek Watershed District.
2. Burning or burying of vegetative matter or wood is not permitted. All woody material must be chipped. Vegetative material may be composted at an approved site.
3. Contractor responsible for removing all abandoned fencing and dump site materials including metals, tires and plastics. Materials shall be recycled when possible.
4. Rocks or boulders shall be stockpiled at an approved site.
5. All stumps and root mass shall be excavated, chipped and removed. Grading of stumps is not permitted.
3. Deciduous hardwood trees greater than 12" within or on the edge of fairways shall be flagged and review by owner prior to removal.



2020 Golf Course Improvements
 Indian Hills Golf Club
 6667 Keats Avenue North, Grant, MN 55082
 Mike Regan, Owner

Site Clearing & General Grading Plan
 Grant Township Condition Use Permit Application



Golf Course Architect:

Site Clearing & General Grading Plan

Issue Date: April 9, 2020

Scale: 1" = 100 FT

0 100 200 FT



2020 Copyright Gill Design, Inc.

City of Grant: Future Land Use and Zoning

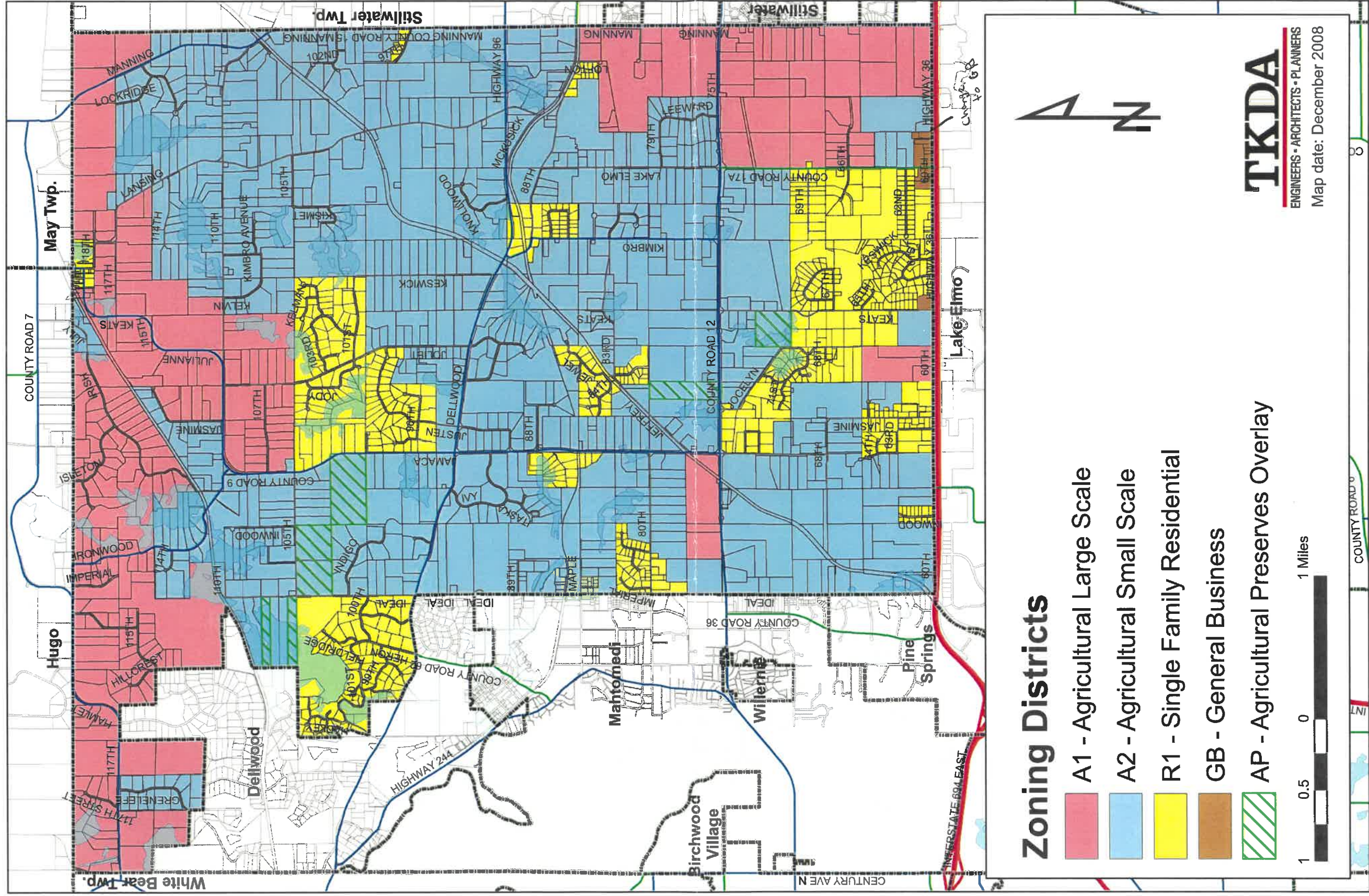

Source: Metropolitan Council, TKDA

LATEST HISTORY
 THIS PROJECT HAS BEEN REVIEWED AND APPROVED BY THE WASHINGTON STATE DEPARTMENT OF TRANSPORTATION (WSDOT) FOR THE DESIGN AND CONSTRUCTION OF THE PROJECT. THE PROJECT IS A PART OF THE STATE ROUTE 162 CORRIDOR IMPROVEMENT PROJECT. THE PROJECT IS A PART OF THE STATE ROUTE 162 CORRIDOR IMPROVEMENT PROJECT. THE PROJECT IS A PART OF THE STATE ROUTE 162 CORRIDOR IMPROVEMENT PROJECT.

NO.	DESCRIPTION
1	STATE ROUTE 162
2	STATE ROUTE 162
3	STATE ROUTE 162
4	STATE ROUTE 162
5	STATE ROUTE 162
6	STATE ROUTE 162
7	STATE ROUTE 162
8	STATE ROUTE 162
9	STATE ROUTE 162
10	STATE ROUTE 162

NO.	DESCRIPTION
1	STATE ROUTE 162
2	STATE ROUTE 162
3	STATE ROUTE 162
4	STATE ROUTE 162
5	STATE ROUTE 162
6	STATE ROUTE 162
7	STATE ROUTE 162
8	STATE ROUTE 162
9	STATE ROUTE 162
10	STATE ROUTE 162



DEPARTMENT OF TRANSPORTATION

GENERAL NOTES
 1. ALL PROVISIONS AND REQUIREMENTS ARE TO BE OBSERVED.
 2. THE CONTRACTOR SHALL BE RESPONSIBLE FOR OBTAINING ALL NECESSARY PERMITS.
 3. THE CONTRACTOR SHALL BE RESPONSIBLE FOR OBTAINING ALL NECESSARY PERMITS.
 4. THE CONTRACTOR SHALL BE RESPONSIBLE FOR OBTAINING ALL NECESSARY PERMITS.
 5. THE CONTRACTOR SHALL BE RESPONSIBLE FOR OBTAINING ALL NECESSARY PERMITS.
 6. THE CONTRACTOR SHALL BE RESPONSIBLE FOR OBTAINING ALL NECESSARY PERMITS.
 7. ALL EXISTING UTILITIES SHALL BE PROTECTED AND DEPTH SHALL BE DETERMINED.

